



## 6 Cherry Croft

Croxley Green, Croxley Green, WD3 3AL

Price Guide £525,000

Nestled in the tranquil private road of Cherry Croft, Croxley Green, this modern terraced house offers a delightful blend of comfort and convenience. Spanning an impressive 872 square feet, the property features two well-proportioned bedrooms and modern bathroom, making it a great choice for young families or professionals seeking a peaceful retreat. Close to the park, primary schools and shops.

Built in 2001, the house boasts a contemporary design that is both stylish and functional. The reception room provides a welcoming space for relaxation and entertaining, while the conservatory extends the living area, allowing for an abundance of natural light and a seamless connection to the outdoors. The kitchen breakfast room is perfect for casual dining, offering a practical space for culinary pursuits. East facing good sized rear garden. Ground floor WC

- Mid terraced modern house
- Lovely quiet location
- Close to schools, shops and met lien station
- Hallway
- Reception room
- Kitchen
- Conservatory
- 2 beds
- Bathroom
- Groubd Floor WC

### Viewing

Please contact our Grosvenor Estate Agents Ltd Office on 01923 711651 if you wish to arrange a viewing appointment for this property or require further information.



## Floor Plan

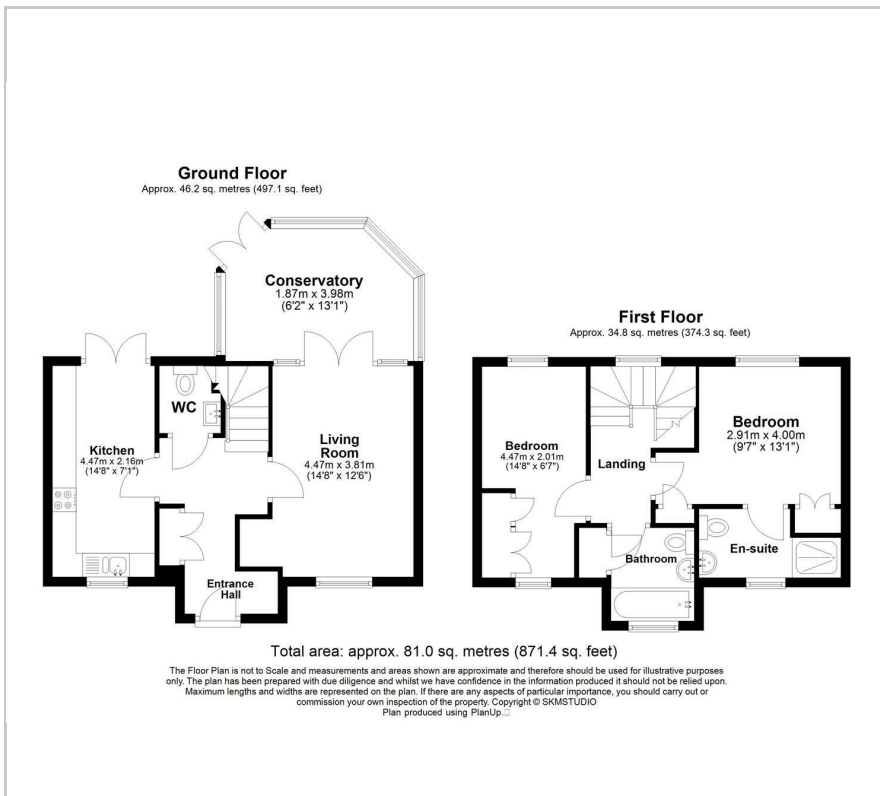

## Area Map



## Energy Efficiency Graph

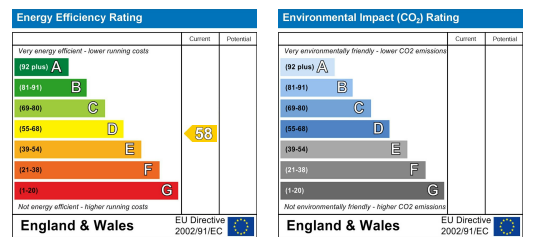

These particulars, whilst believed to be accurate are set out as a general outline only for guidance and do not constitute any part of an offer or contract. Intending purchasers should not rely on them as statements of representation of fact, but must satisfy themselves by inspection or otherwise as to their accuracy. No person in this firm's employment has the authority to make or give any representation or warranty in respect of the property.

163 New Road, Croxley Green, Hertfordshire, WD3 3HB

Tel: 01923 711651 Email: sales@grosvenorestateagents.co.uk www.grosvenorstates.co.uk